

1 COLUMN NOTCH
SCALE: N/A

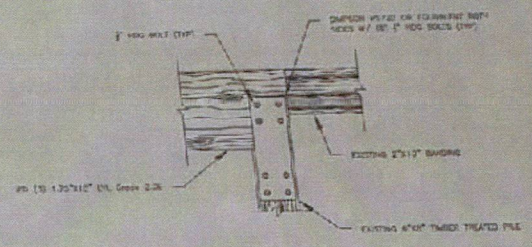

2 COLUMN NOTCH
SCALE: N/A

NOTES:

1. COLUMNS SHALL BE NOTCHED TO RECEIVE 2"x10" TREATED TIMBER BANDING COINCIDING WITH ORIGINAL BUILDING STRUCTURE.
2. LVL COMPOSITE BEAM SHALL BE INSTALLED PRIOR TO REMOVAL OF (2) COLUMNS TO BE REMOVED.
3. CONTRACTOR SHALL ENSURE ALL ADDITIONAL FRAMING NOT SPECIFIED IN THIS DRAWING IS INSTALLED IN ACCORDANCE WITH THE 2018 NORTH CAROLINA BUILDING CODE.

REVISIONS			
NO.	DATE	DESCRIPTION	BY

DEATON AIR HANGER ADDITION

DEAFON	CARTERSVILLE COUNTY	NORTH CAROLINA
OWNER: JEFF DEATON	DESIGNED:	
ADDRESS: 2200 W. HUNTER RD. BLDG. 100	DRAWN:	
PHONE: (252) 524-1000	APPROVED:	
	DATE: 2/3	
	SCALE: AS SHOWN	
	SHEET: 02	

STROUD ENGINEERING, P.A.
10146 SHAWNEE STREET
GREENVILLE, NORTH CAROLINA 27608
(756) 794-9452



Joshua L. Johnson
JOSHUA L. JOHNSON, P.E.

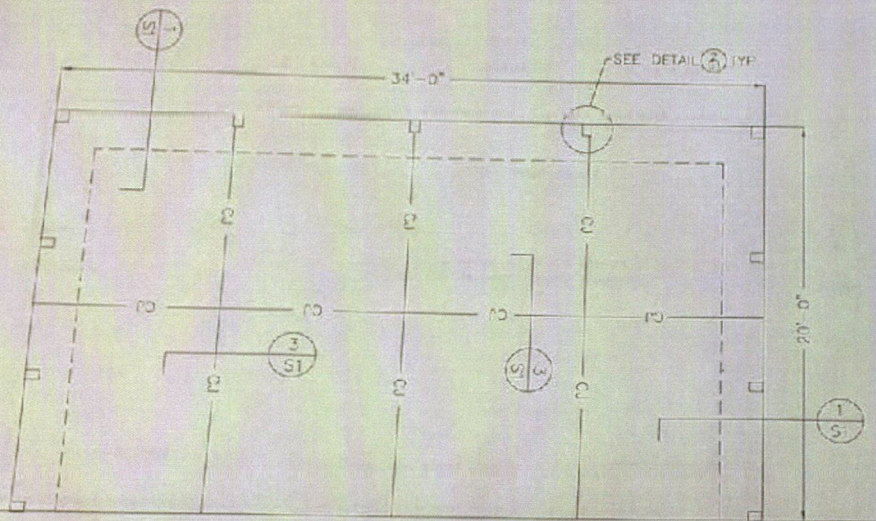

FOUNDATION PLAN

SCALE: 3/8"=1'-0"

A
SI

NOTES:

1. ALL FOOTINGS SHALL BEAR ON UNDISTURBED SOIL CAPABLE OF SUPPORTING A DESIGN BEARING PRESSURE OF 2000 PSF.
2. ALL CONCRETE INCLUDING SLAB-ON-GRADE SHALL OBTAIN A COMPRESSIVE STRENGTH OF 3000 PSI AT AN AGE OF 28 DAYS.
3. ALL REINFORCING STEEL SHALL BE IN ACCORDANCE WITH ASTM A-610, GRADE 60.
4. CONCRETE PROTECTION OF REINFORCING STEEL AND OTHER GENERAL REQUIREMENTS FOR FABRICATION AND PLACING OF REINFORCING STEEL SHALL BE IN ACCORDANCE WITH THE LATEST EDITION OF THE AMERICAN CONCRETE INSTITUTE BUILDING CODE (A.C.I. 318-10).
5. ALL REINFORCING MARKED CONTINUOUS (CONT.) ON THE PLANS AND DETAILS SHALL BE LAPPED 36 X BAR DIAMETER AT SPICES UNLESS OTHERWISE NOTED.
6. REINFORCING STEEL (TOP AND BOTTOM) SHALL PASS THROUGH THE TIMBER COLUMNS CREATING A CONNECTION BETWEEN THE COLUMN AND THE CONCRETE FOOTING.
7. COLUMNS SHALL BE EMBEDDED A MINIMUM OF 6 FEET. IF FIBER REINFORCED CONCRETE IS USED, WIRE MESH IS NOT REQUIRED.

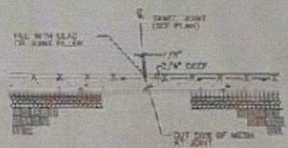

NOTE: SAW CUT SHOULD BE MADE AS SOON AS CONCRETE HAS CURED SUFFICIENTLY TO ALLOW EXPOSURE TO TRAFFIC ON SLAB.

SAWED JOINT DETAIL
3
SI

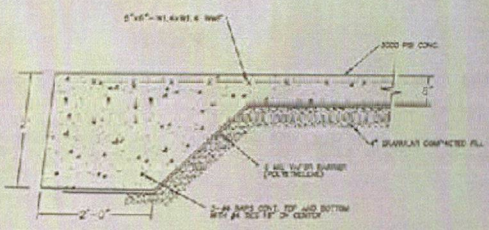

PERIMETER FOOTING
1
SI

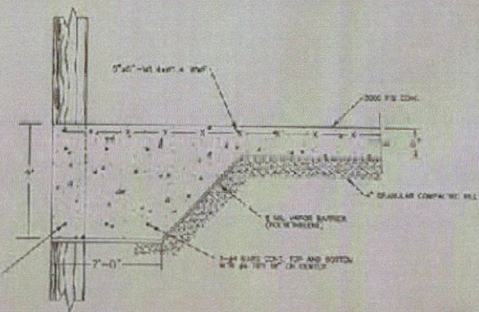

PERIMETER FOOTING
1
SI

REVISIONS	
REV. NO.	DESCRIPTION

FOUNDATION PLAN

DEATON AIR HANGER ADDITION

REPORT	CARTER COUNTY	NORTH CAROLINA
OWNER:	LEI DEATON	DESIGNED: J.L.
ADDRESS:	7500 30th STREET W. SW	DRAWN: J.L.
PHONE:	(252) 521-4088	APPROVED: J.L.
STROUD ENGINEERING, P.A.		DATE: 2/3/18
107 S. COMMERCIAL STREET GREENVILLE, NORTH CAROLINA 27639 (252) 796-6762		SCALE: AS SHOWN
LEAD: M.L. 1047		SHEET 01 OF 01



JOHNSON, P.E.

NOTES:

1. ALL FOOTINGS SHALL BEAR ON UNDISTURBED SOIL CAPABLE OF SUPPORTING A DESIGN BEARING PRESSURE OF 2000 PSF.
2. ALL CONCRETE INCLUDING SLAB-ON-GRADE SHALL OBTAIN A COMPRESSIVE STRENGTH OF 3000 PSI AT AN AGE OF 28 DAYS.
3. ALL REINFORCING STEEL SHALL BE IN ACCORDANCE WITH ASTM A-615, GRADE 60.
4. CONCRETE PROTECTION OF REINFORCING STEEL AND OTHER GENERAL REQUIREMENTS FOR FABRICATION AND PLACING OF REINFORCING STEEL SHALL BE IN ACCORDANCE WITH THE LATEST EDITION OF THE "AMERICAN CONCRETE INSTITUTE BUILDING CODE" (A.C.I. 318-19).
5. ALL REINFORCING MARKED CONTINUOUS (CONT.) ON THE PLANS AND DETAILS SHALL BE LAPPED 36 X BAR DIAMETER AT SPLICES UNLESS OTHERWISE NOTED.
6. REINFORCING STEEL (TOP AND BOTTOM) SHALL PASS THROUGH THE TIMBER COLUMNS CREATING A CONNECTION BETWEEN THE COLUMN AND THE CONCRETE FOOTING.
7. COLUMNS SHALL BE EMBEDDED A MINIMUM OF 6 FEET.
8. IF FIBER REINFORCED CONCRETE IS USED, WIRE MESH IS NOT REQUIRED.

Ⓢ SAWED JOINT
| (SEE PLAN)